

Verlegeanleitung Laminatboden

CLASSEN®

Verlegesystem Taploc 3.X im Dielenformat
ohne integrierte Trittschalldämmung



Rev. 1.2/07.24

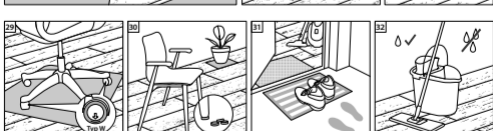
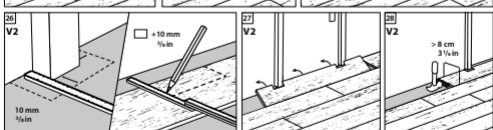
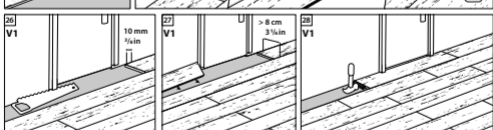
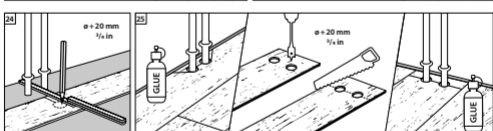
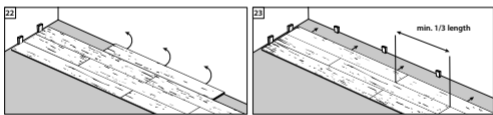
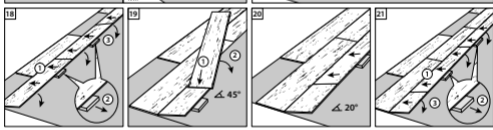
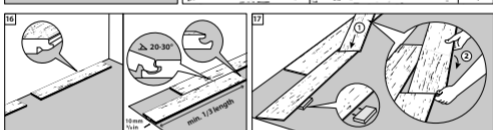
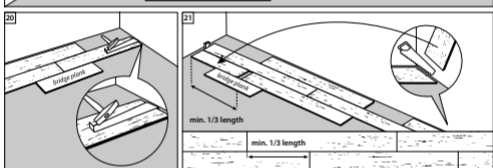
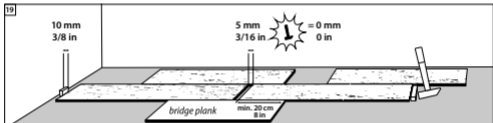
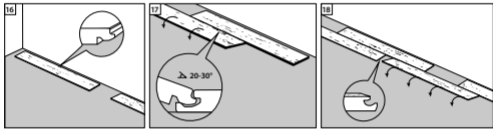
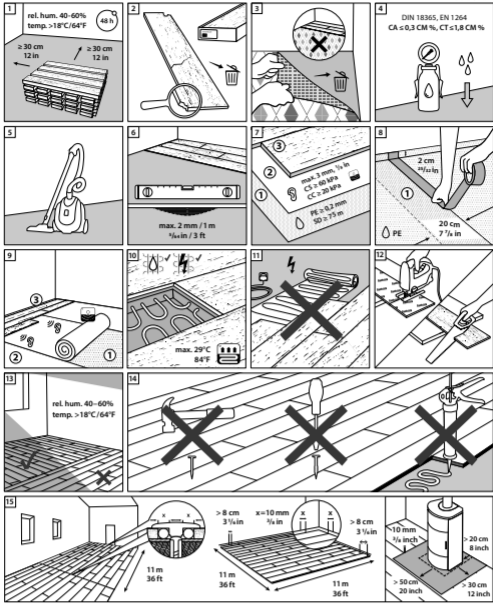

1: PE foam baker rod / PE Schaum Band, 2: Silicone / Silikon, 3: Molding / Leiste

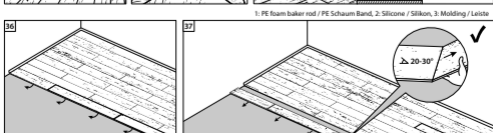

QR-Code zu den

- Verlegeanleitungen in Textform
- Reinigungs- und Pflegehinweisen
- Technischen Datenblättern
- Produktzertifikaten